



Public Information Meeting



Tonight's Agenda

Project Goals

Proposed Project Process and Scope

Project Funding

Questions and Answers



Project Goals

The scope of the proposed capital project can be broken into four main areas as follows:

- **Required Building Maintenance**
- **Safety and Security Upgrades**
- **Improve/Maximize Space Renovations**
- **Fiscal Responsibility**



Project Planning Process

- **Previous Capital Project**
- **2010 Building Condition Survey**
- **5-Year Facilities Plan**
- **Capital Planning Meetings**
- **Phases of a Capital Project**





Grimshaw Elementary

Proposed Capital Project Work



Building Maintenance

- **Building Envelope**

Roofing, Windows, Doors, Masonry

- **Building Systems**

Electrical, Clocks, Telephones, Domestic Hot Water, HVAC, Flooring

- **Site Restoration**

Fuel Tank Removal, Asphalt & Sidewalks

- **Miscellaneous Renovations**

Restrooms, Loading Dock, Basement Lift







Safety & Security

- **Relocate Main Office/Entrance**
- **Secure Daytime Entrance Addition**
- **Door Security & Cameras**
- **New Parent Drop Off & Parking Reconfiguration**
- **Courtyard Reconfiguration**
- **Relocate & Expand Playground**



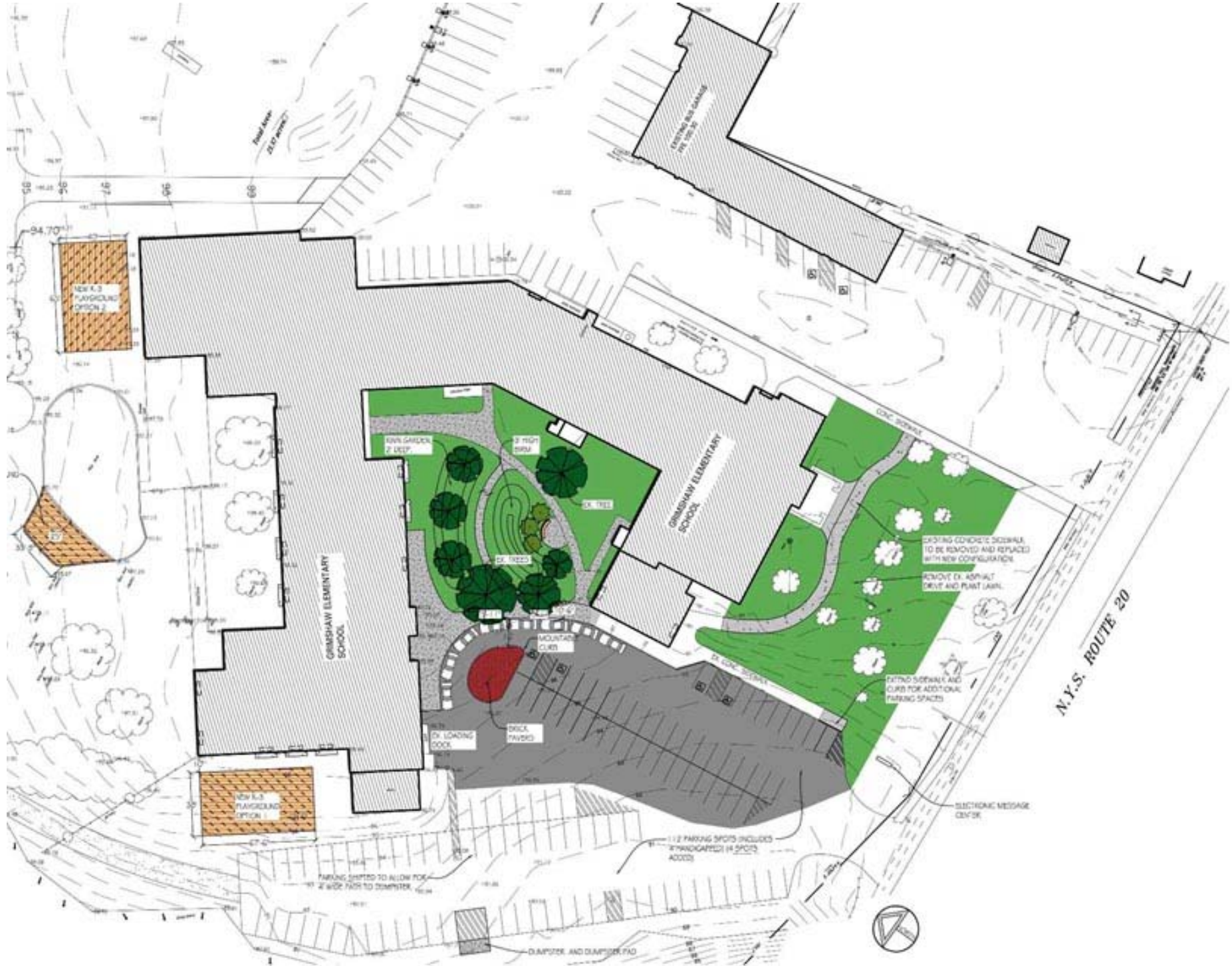

Grimshaw Elementary

10/15/13



Improve/Maximize Spaces

- **Nurse Suite Relocation**
- **Existing Office/Nurse Suite Reconfiguration**
- **Conference Room**
- **Pre-K Classroom**
- **Kitchen Serving & Cafeteria Acoustics**









Grimshaw Elementary

10/15/13



LaFayette Jr/Sr High School

Proposed Capital Project Work



Building Maintenance

- **Building Envelope**

Roofing, Skylights, Window Insulation, Masonry

- **Building Systems**

Electrical, Lighting, Telephones, Domestic Water (Hot & Cold), Boilers, Ventilation, Sanitary, Elevator, Flooring

- **Site Restoration**

Fuel Tank Removal, Asphalt Paving & Bus Loop, Concrete Stairs





Safety & Security

- **Reconfigure Main Office/Entrance/Lobby**
- **New Secure Daytime Entrance Addition at Big Picture**
- **Door Security & Cameras**
- **Widen Bus Loop**
- **Cafeteria Vision Window**





13



JR/SR High School

10/15/13

Improve/Maximize Space

- **Big Picture Relocation/Renovations**
- **Art Room Renovations**
- **Auditorium Upgrades**
- **LGI Reconstruction into New Music Suite**
- **Project Lead the Way & Other Classroom Reconfigurations**
- **Faculty, Conference Room, and AD Office Improvements**
- **New Exterior Half-Court Basketball Play Area**





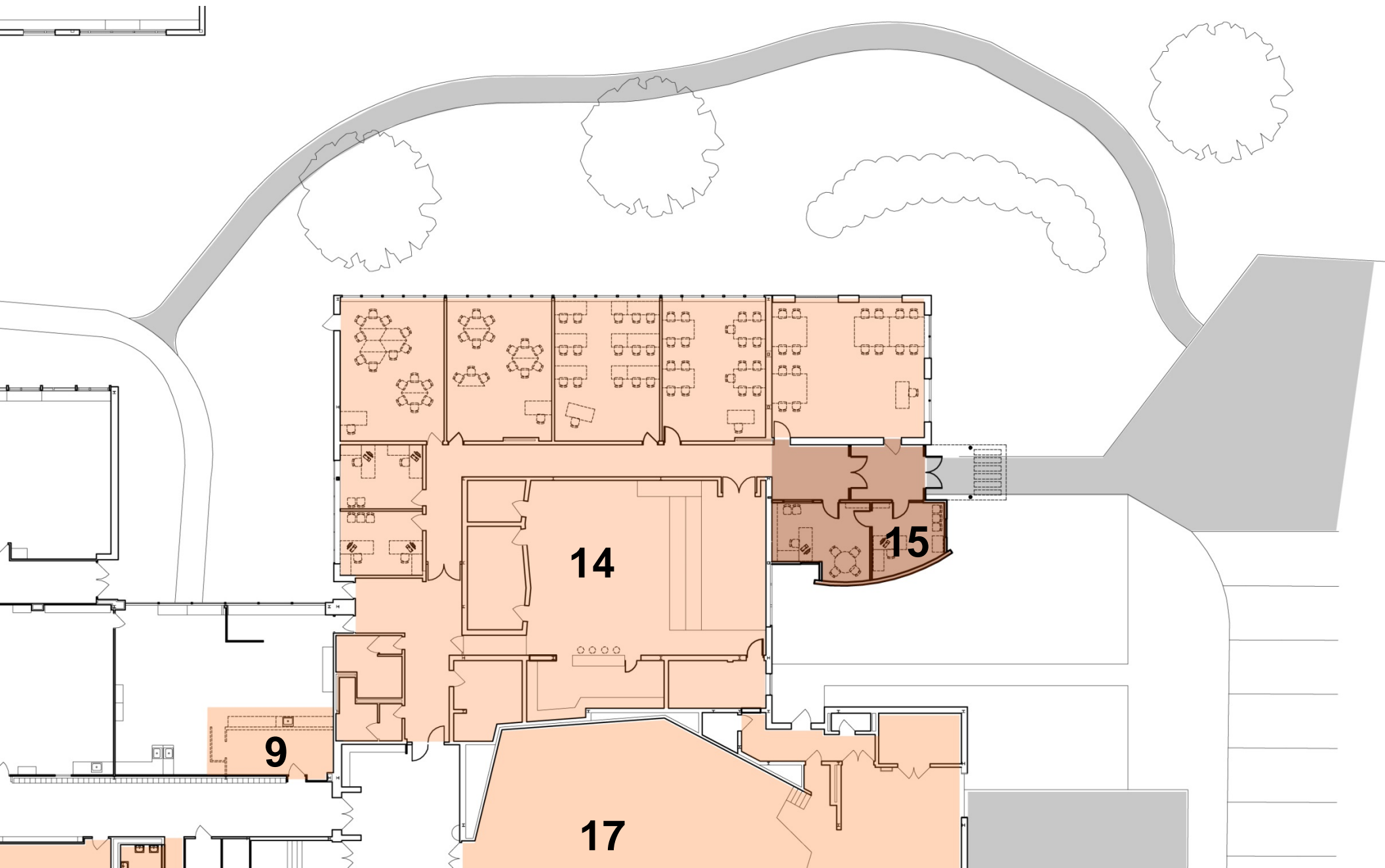

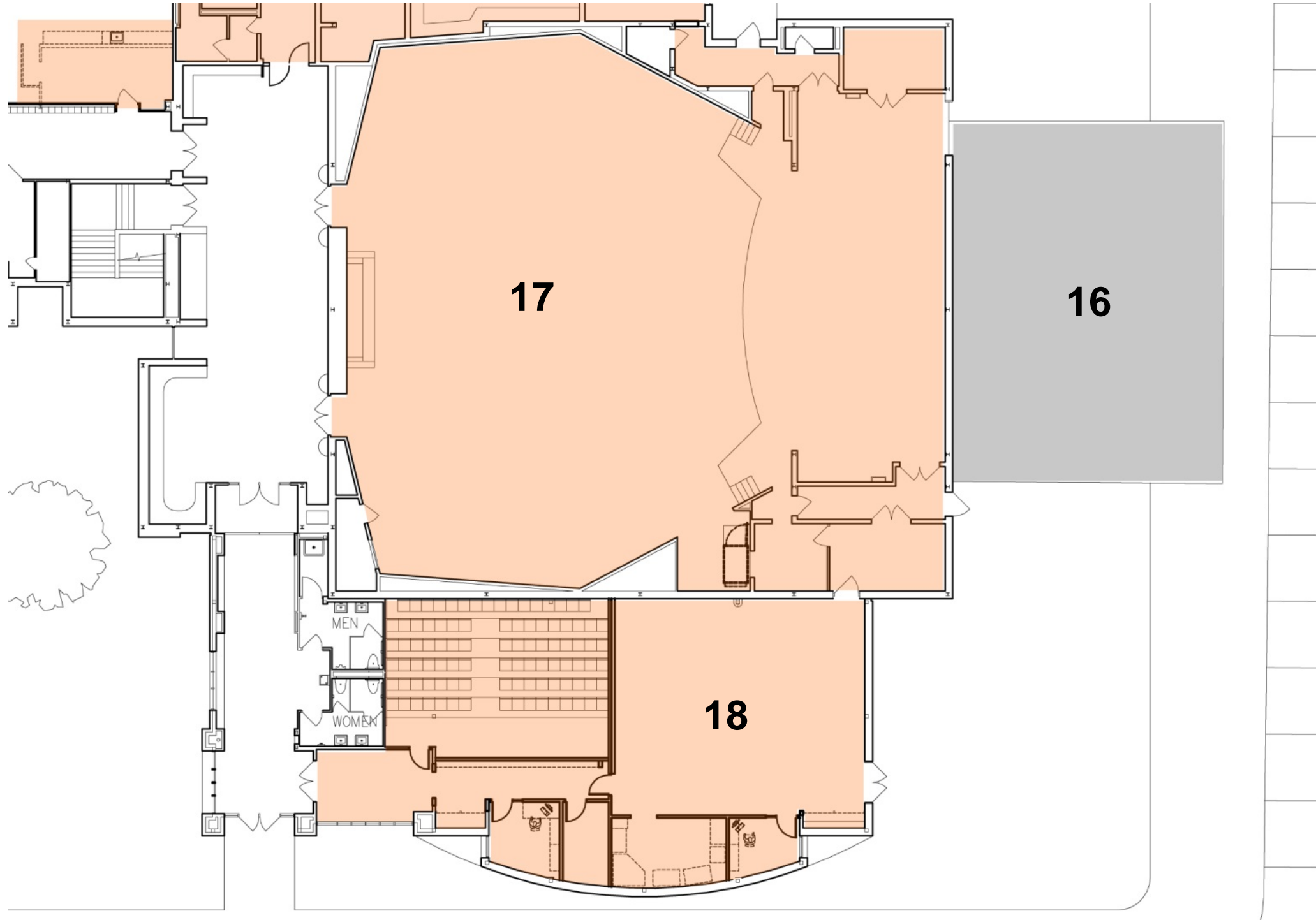



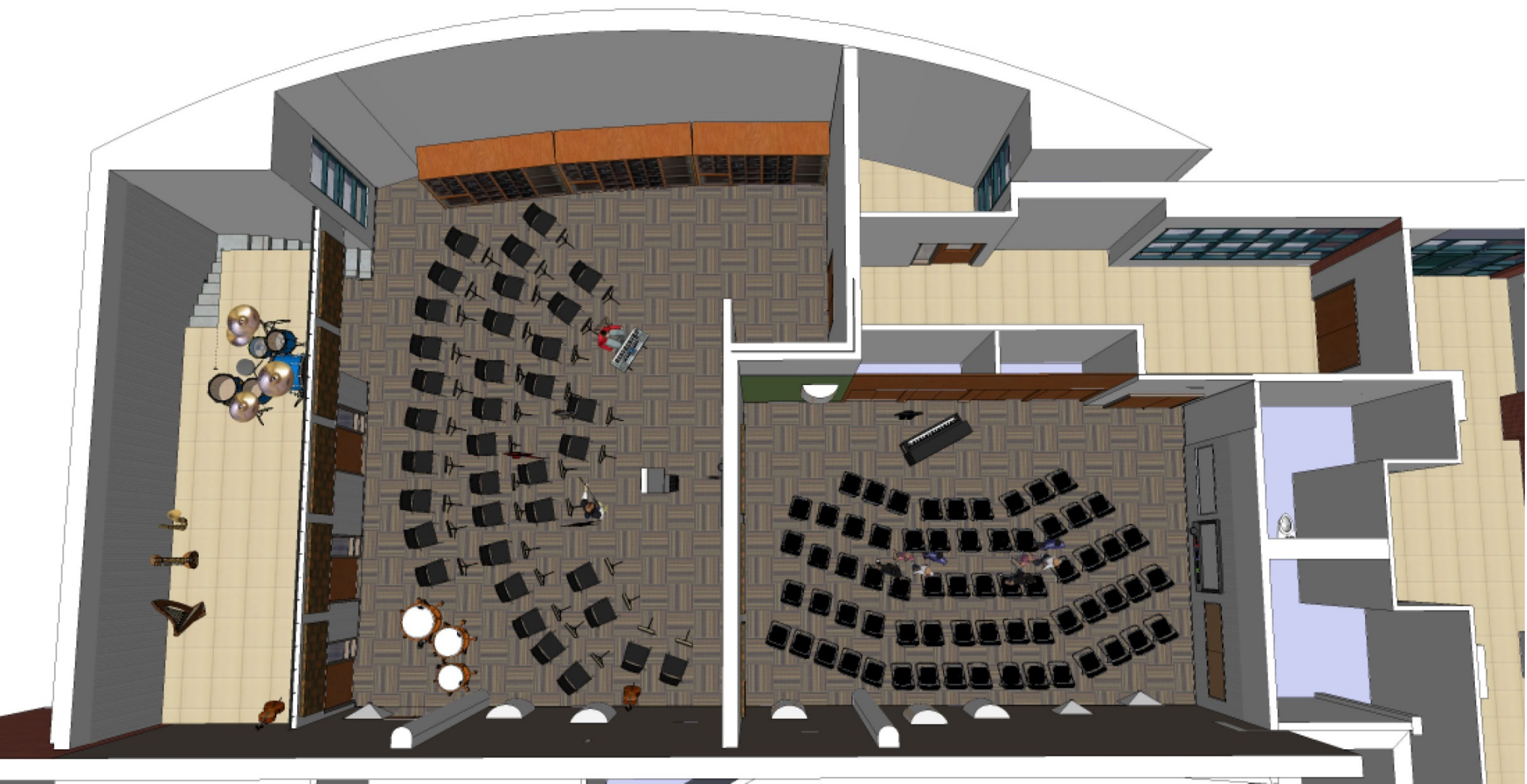

Project Cost by Component

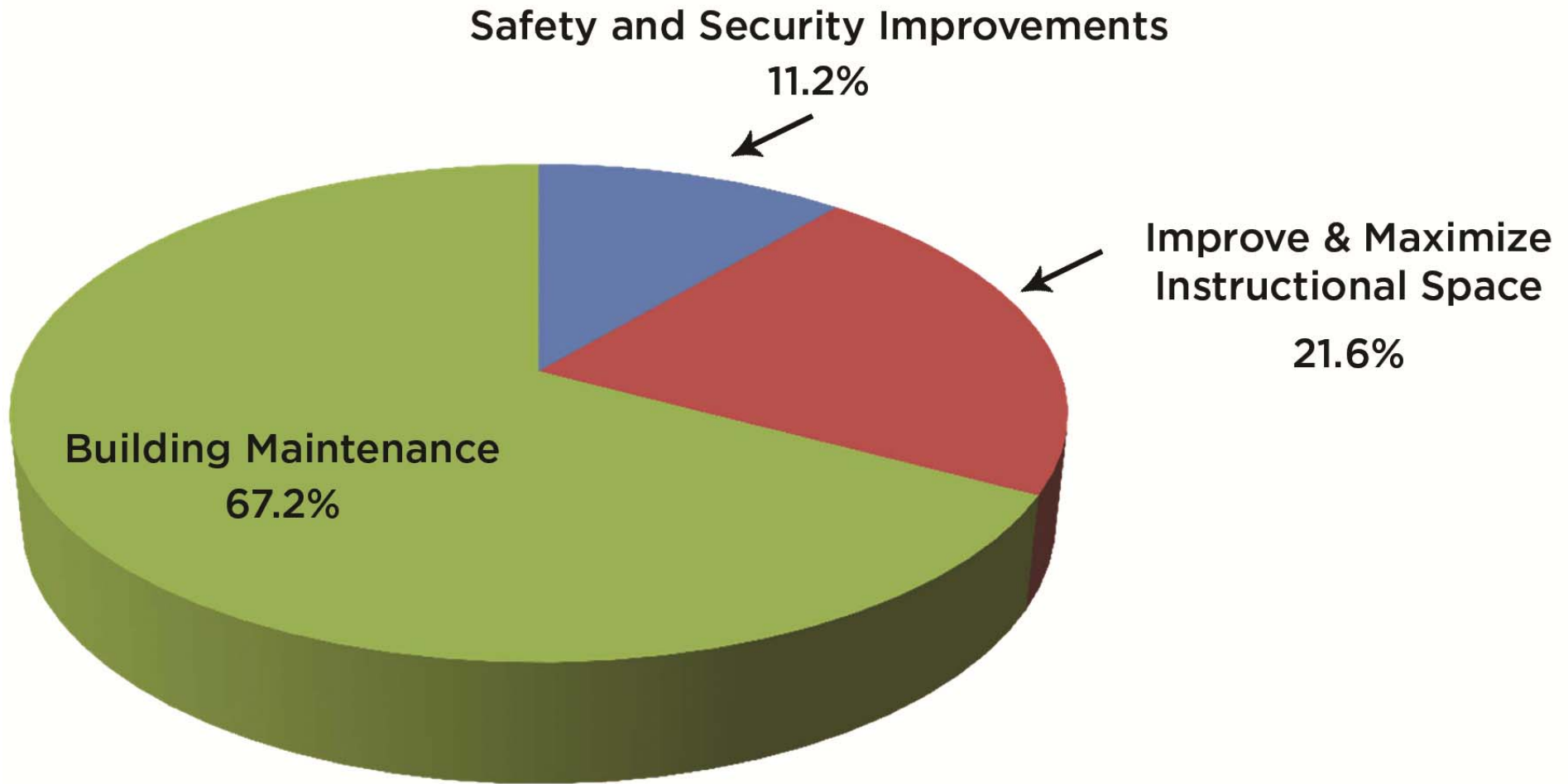

Funding Sources

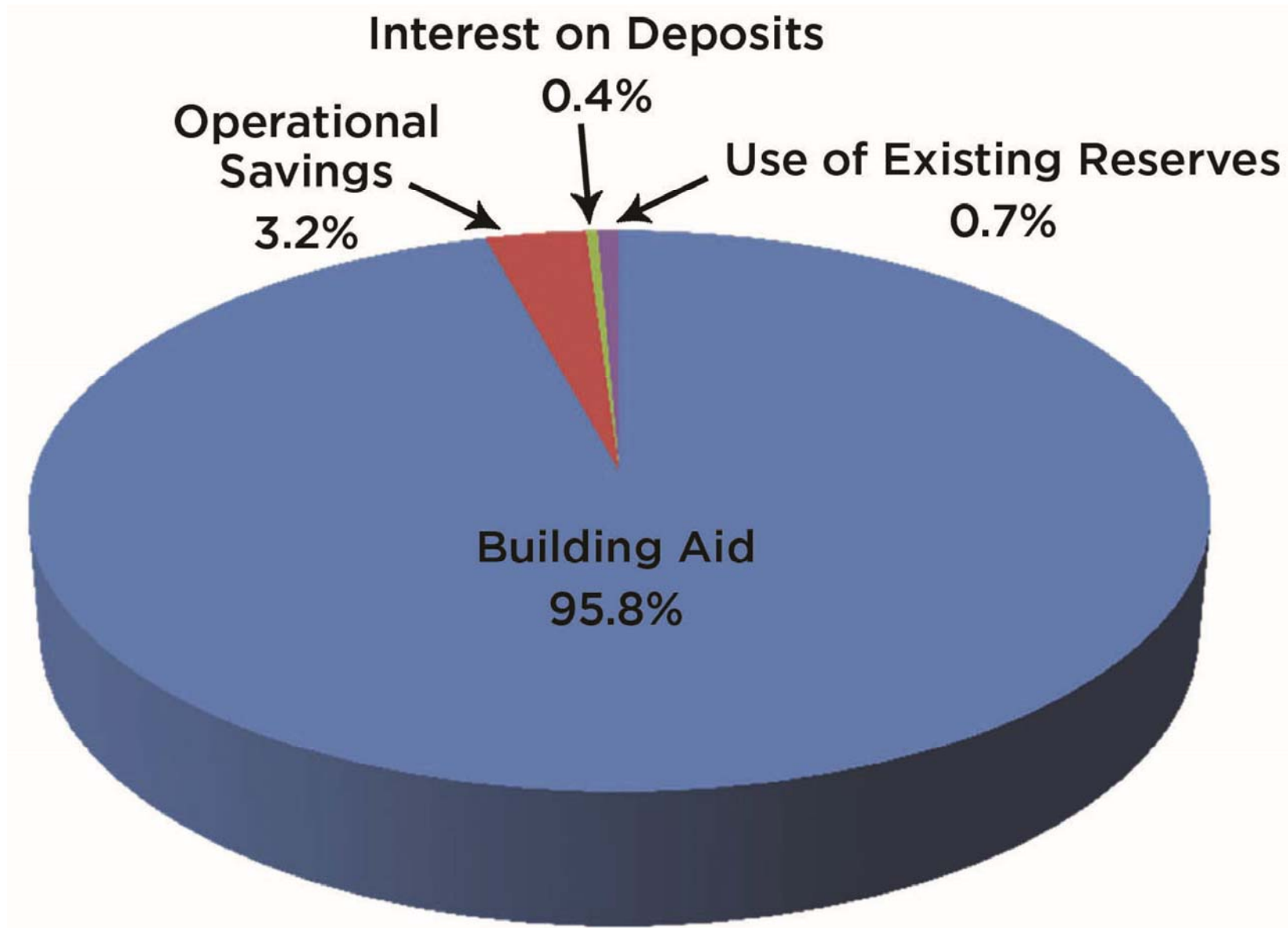

TYPICAL ANTICIPATED COSTS FOR A CAPITAL PROJECT FUNDING:

When creating a budget for a Capital Project, certain fixed and anticipated costs must be accounted for:

- Design Contingency
- Construction Contingency
- Incidentals (Soft Costs)
 - Architectural/Engineering Professional Services
 - Construction Administration/Construction Management Services
 - Soils, Surveys, Testing and Monitoring
 - Furniture, Fixtures & Equipment (FF&E)
 - Legal Fees
 - Insurances
 - Bonding Costs
 - Printing & Reproduction Expenses
 - Other
- Escalation Factor

Estimates are general in nature and are used for budget planning purposes only.





Public Comment

